

USER MANUAL

Digital Alcohol Tester

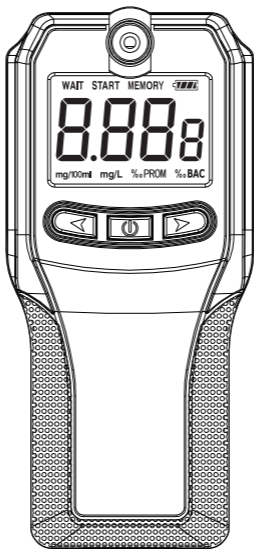

Model: EK-912

Please read these instructions carefully before use, to prevent damage to your new product.

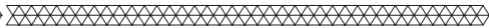

Table of Contents

- **1. Introduction**
 - 1. Warnings and Safety Instructions
 - 2. Receiving Your Shipment
 - 3. Ordering Information

- **2. Contents of the Package**

- **3. Product Features**
 - 1. Product Overview
 - 2. Product Specifications
 - 2.1 Technical Data
 - 2.2 Performance Specifications
 - 2.3 Unit Explanation
 - 2.4 Comparison Chart of Alcohol Concentration

- **4. Operating Instructions**
 - 1. Operating the Digital Breathalyzer
 - 2. Other Functions

- **5. Maintenance and Cleaning**

- **6. Storage**

- **7. Disposal-Recycle**



1.0 Introduction

- Thank you for choosing our product! To ensure proper and safe functioning of the product, please read the user manual carefully before use. Please always follow the instructions for safe usage. If you have any questions about the product or experience any problems, please contact us
- The Digital Breathalyzer is a quick, easy, and reliable way to test your BAC (Blood Alcohol Concentration). The device is portable and easy to use. Your BAC results are displayed after 10 seconds on a bright, easy to read VA screen. You can change the units of measurement and set a user-defined BAC threshold for testing. Remember: do NOT drink and drive or operate other machinery!

1.1 Warnings and Safety Instructions

- Due to the physical difference of every person, the test results vary from person to person. The testing results of the Digital Breathalyzer are for reference only. The Digital Breathalyzer is NOT similar to the devices used by law enforcement. This test and your test result CAN NOT be used as juridical proof in case of law encounters. is not responsible or liable for any behaviour that might break the law.

Before using your Digital Breathalyzer, read the following:

- If you have not used the Digital Breathalyzer before, it is important that you read and follow the instructions as stated in the user manual. Be aware of the risks and consequences resulting from misuse of the Digital Breathalyzer. Misuse of the Digital Breathalyzer can result in personal injury, or destruction of the device and of the installations.
- This device should NOT be used by persons (including children) with physical, sensory or mental disabilities, or persons (including children) with lack of experience with and knowledge of the device, unless they are supervised or have been given instruction concerning the use by a person responsible for their safety.
- Use the Digital Breathalyzer only for purposes described in this user manual.
- The Digital Breathalyzer is designed and intended for private, non-commercial use only.
- Do NOT drink and drive or operate other machinery. Do NOT let another person drink and drive or operate other machinery. Make sure to always assign a designated driver.
- The alcohol level in your blood can keep increasing up to 2 hours after drinking your last alcoholic beverage. A continuous negative test result cannot be guaranteed.

- Excessive drinking can damage your health.
- Do NOT drink or smoke for at least 20 minutes before testing. Rinse your mouth with water before testing.
- Only perform the test in a temperature range between 0°C - 45°C. Performing the test in temperatures outside of this range can lead to false test results.
- For better performance and a longer battery life, avoid using the product at extreme high or extreme low temperatures or in a static environment, such as in hot weather or a sun-baking car, besides a fire, on a hot surface or in a cold environment.
- Do NOT blow smoke, liquid or food residue into the device.
- Conditions that increase the amount of ketones on your breath, such as diabetes or low calorie intake may cause false test results.
- Do NOT clean the Digital Breathalyzer with any chemical detergents.
- Use a standard 5V adaptor to charge the product.
- Do NOT reconstruct, repair or disassemble the product. This can damage the device.
- Keep the Digital Breathalyzer away from children when using and storing.

1.2 Receiving your Shipment

- When receiving your shipment, make sure that the contents are consistent with the packing list. Notify your distributor of any missing items. If the equipment appears to be damaged, file a claim immediately with the carrier and notify your distributor at once, giving a detailed description of any damage. Save the damaged packing container to substantiate your claim.

1.3 Ordering Information

- Digital Breathalyzer - Model EK-912 - EAN 8720195250180

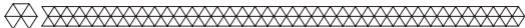

2.0 Contents of Package

- Digital Breathalyzer - Model EK-912 - EAN 8720195250180

Included Accessories

- | | |
|--------------------|--------------------|
| A: Breathalyzer x1 | B: Mouthpieces x10 |
| C: USB cable x1 | D: User manual x1 |
| E: Storage bag x1 | |





3.0 Product Features

3.1 Product Overview

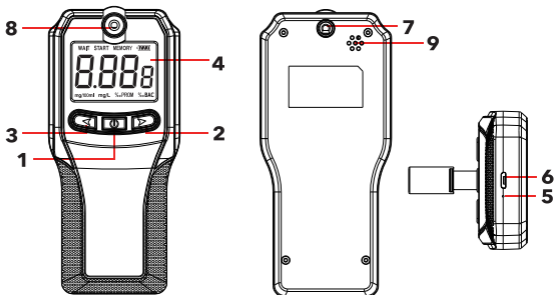

- 1. Power button
- 2. Right button
- 3. Left button
- 4. VA screen
- 5. Charging indicator light
- 6. USB-charging port
- 7. Ventilation hole
- 8. Collapsible mouthpiece hole
- 9. Alarm

3.2 Product specifications

3.2.1 Technical data

Charging Voltage	5V	Weight	126g
Battery Capacity	Lithium Battery 1000mAh	Warm-up Time	<10s
Working Current	≈50mA	Blowing Time	4.5s
Continue Testing Times	800~1000 times	Response Time	<5s
Working Temperature	0°C - 45°C	Sensor:	Fuel cell sensor
Charging Time	3h	Size	135x62x22mm

- 3.2.2 Performance Specifications

- Testing Range:

0.000~0.500 %BAC

0.000~5.000 ‰BAC

0.000~2.500 mg/L

0.000~0.500 g/L

0~500 mg/100ml

0.000~5.000 ‰PROM

NOTE: HI is displayed if the detection result is out of detection range

- 3.2.3 Unit explanation

BAC	Blood Alcohol Concentration (The percent of alcohol in a person's bloodstream)
%BAC	How many grams of alcohol are present in 100ml of blood
‰BAC	How many grams of alcohol are present in 1000ml of blood
g/L	How many grams of alcohol are present in one litre of blood
mg/100mL	How many milligrams of alcohol are present in 100ml of blood
BrAC	Breath Alcohol Concentration (The percent of alcohol in a person's breath)
mg/L	How many milligrams of alcohol are present in one litre of blood

- 3.2.4 Comparison Chart of Alcohol Concentration

%BAC ----- America

g/L ----- Europe

mg/LBrAX ----- Japan

mg/100ML -----China

See table on the next page.

%BAC	‰BAC	‰Prom	g/L	mg/100ml	mg/L	PPM
0.01	0.1	0.1	0.1	10	0.05	25
0.02	0.2	0.2	0.2	20	0.1	50
0.03	0.3	0.3	0.3	30	0.15	75
0.04	0.4	0.4	0.4	40	0.2	100
0.05	0.5	0.5	0.5	50	0.25	125
0.06	0.6	0.6	0.6	60	0.3	150
0.07	0.7	0.7	0.7	70	0.35	175
0.08	0.8	0.8	0.8	80	0.4	200
0.09	0.9	0.9	0.9	90	0.45	225
0.1	1	1	1	100	0.5	250
0.11	1.1	1.1	1.1	110	0.55	275
0.12	1.2	1.2	1.2	120	0.6	300
0.13	1.3	1.3	1.3	130	0.65	325
0.14	1.4	1.4	1.4	140	0.7	350
0.15	1.5	1.5	1.5	150	0.75	375
0.16	1.6	1.6	1.6	160	0.8	400
0.17	1.7	1.7	1.7	170	0.85	425
0.18	1.8	1.8	1.8	180	0.9	450
0.19	1.9	1.9	1.9	190	0.95	475
0.20	2	2	2	200	1	500

1. If the deviations of 2 successive readings are both larger than 0,01%BAC or 0.1‰BAC or 0.05mg/L, you need to take the test again.
2. Do not block the side air outlet when you're blowing
3. There will be a deviation between the testing value and the true value when the battery of the product is running low. Use the Digital Breathalyzer when it is fully loaded.
4. The testing results cannot be used as evidence in court
5. Do not indulge in excessive drinking.



4.0 Operating Instructions

4.1 Unit settings

1. Press the Power button for 2 seconds. In the upper left corner of the screen the word "WAIT"
During this countdown, press the left button to start the setting mode to enter the preferred unit.
2. When you are in the unit setting mode, press the left button to turn to the next page and press the right button to go to the previous page. Select your preferred unit (%BAC, ‰BAC, mg/L, g/L, mg/100ml, ‰PROM).
3. After selecting the preferred unit, press the Power button to secure the unit setting and exit the unit mode

Alert Triggering Value (Warning/Danger Value) Settings

You can customize the warning and danger value according to your local standard of the legal alcohol limit when driving.

There are 3 indications:

- a. Safe: Indicates a safe state.
 - b. Warning: Alert, indicates a warning state before the drunk driving state. The alarm will make a beeping sound.
 - c. Danger: Indicates a drunk driving state. The alarm will make a beeping sound that will last for 10 seconds.
1. Turn on the Digital Breathalyzer. In the upper left corner of the screen the word "WAIT"
Press the Right button to start the setting mode to enter the alert triggering value.
 2. When you have entered the setting mode, press the left button to increase the warning value and press the right button to decrease the warning value. Press the Power button to save your setting and to start the setting mode to enter the danger value.
 3. When you have entered the setting mode, press the left button to increase the danger value and press the right button to decrease the danger value. Press the Power button to save the trigger value settings and to exit the unit setting mode. You will automatically go back to the alcohol testing mode.

Default value of triggering alarm

	%BAC	‰BAC	‰Prom	g/L	mg/100ml	mg/L
Safe	0 - 0.02	0 - 0.2	0 - 0.2	0 - 0.2	0 - 20	0 - 0.1
Warning	0.02 - 0.05	0.2 - 0.5	0.2 - 0.5	0.2 - 0.5	0 - 50	0.1 - 0.25
Danger	≥0.05	≥0.5	≥0.5	≥0.5	≥50	≥ 0.25

Alcohol testing

1. Press the Power button for 2 seconds and the Digital Breathalyzer will turn on after you hear a beeping sound.
2. In the upper left corner of the screen the word "WAIT"
This means that the device is starting its warm-up sequence.

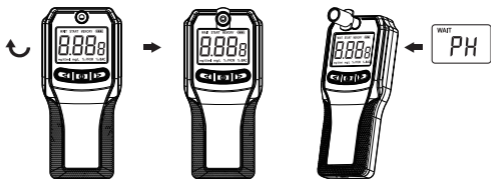

3. After warming-up, the word "START" will be displayed on the screen and the Digital Breathalyzer is ready for use. Make sure to start the test within 10 seconds after the word "START" has appeared. Take a deep breath and blow steadily (softly, continuously and evenly) into the mouthpiece for 4-5 seconds.

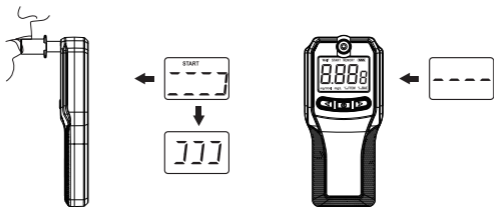

4. Wait for the device to analyse the testing result after blowing, and read the results from the screen.



- 4.2 Other functions

- Restart Mode

1. After you have finished the test and have the results, press the Power button to restart the Digital Breathalyzer. After restarting, the device will start its warm-up sequence automatically and you can take the next test.
2. Wait for at least 3 minutes between each test to get the most accurate test readings.

- Memory Mode

1. After turning the Digital Breathalyzer on, the word "WAIT" will be displayed in the upper left corner of the screen. Press the Power button to enter the memory mode. The Digital Breathalyzer can store and display 123 test results.
2. Press the left button to check the previous test results from oldest to newest.
3. Press the right button to check the previous test results from newest to oldest.
4. Press the Power button to exit the memory mode.

- Automatic Power Off

1. If the Digital Breathalyzer is not used for 15 seconds after showing the last test results, the device will turn off automatically. The word "OFF" will flash twice on the display and the alarm will beep twice.
2. The product will turn off automatically if its warming-up sequence is interrupted.
3. Press the Power button for 2 seconds to turn the Digital Breathalyzer off.

- Low Battery Indication

The battery is low and the Digital Breathalyzer needs to be charged when the power icon in the upper right corner of the screen indicates a low battery or "Lo" appears on the screen after you have turned the device on.

- Charging Indication

When the Digital Breathalyzer cannot be turned on or the battery is running low, you can charge the device with a USB cable (included) and a 5V adapter (not-included). The indicator light turns red when the device is charging, and green when the device is fully charged.

Note: The Digital Breathalyzer will turn off automatically when you plug in the USB charging cable for a more safer use.

- Voltage Protection

The Digital Breathalyzer can be charged with any 5V adapter. If you charge it with a nonstandard adapter, the device will go in auto-protection mode and the charging indicator light will not light up. The charging indicator light will function normally after you switch to a standard 5V adapter to charge the device.

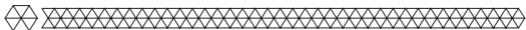

5.0 Maintenance and Cleaning

- Do not clean the Digital Breathalyzer with any chemical detergents. Use a soft, dry anti-static cloth to wipe the device.

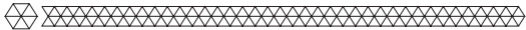

6.0 Storage

- Store the Digital Breathalyzer in a clean dry place. Do not store the device in extreme high or extreme low temperatures.

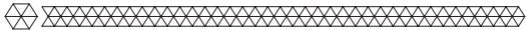

7.0 Disposal - Recycle

- Contribute to a cleaner living environment! Do not dispose of the Digital Breathalyzer with the household waste. For proper recycling, please take these products to a designated collection point. Please contact your local authority or your household waste disposal service for further details of your nearest designated collection point.

